

PART NUMBER

SSA29



BEFORE YOU BEGIN

TOOLS REQUIRED

- › Floor Jack
- › Safety Jack Stands
- › Wheel Chocks
- › ¾" Wrench/Socket
- › ½" Wrench/Socket
- › 3/16" Allen Key
- › Heavy Duty Clamps or SuperSprings Installation Tool

PRIMARY APPLICATIONS

- › Ford Transit Connect 4 X 2 (2010 - 2013)

PARTS LIST

Item	Part #	Discription	QTY
A	102029	SSA29 SuperSpring	2
B	112140	Polyurethane Bushing	8
C	112129	Steel Sleeve	4
D	112189	HDPE Roller	4
E	122400	Angled Shackle	8
F	112124	½-13 x 2 ¾" Hex Bolt	4
G	112125	½-13 x 4 ½" Hex Bolt	4
H	112126	½-13 Nylock Nut	8
I	112127	½" Nylon Flat Washer	16
J	PSP-6	Polyurethane Spring Pad	2
K	112277	Clamp Plate with countersunk holes	2
L	112278	5/16-18 x 1 ½" FHCS	4
M	112221	Clamp Plate	2
N	112209	5/16 Flat Washer	4
O	112208	5/16-18 Nylock Nut	4

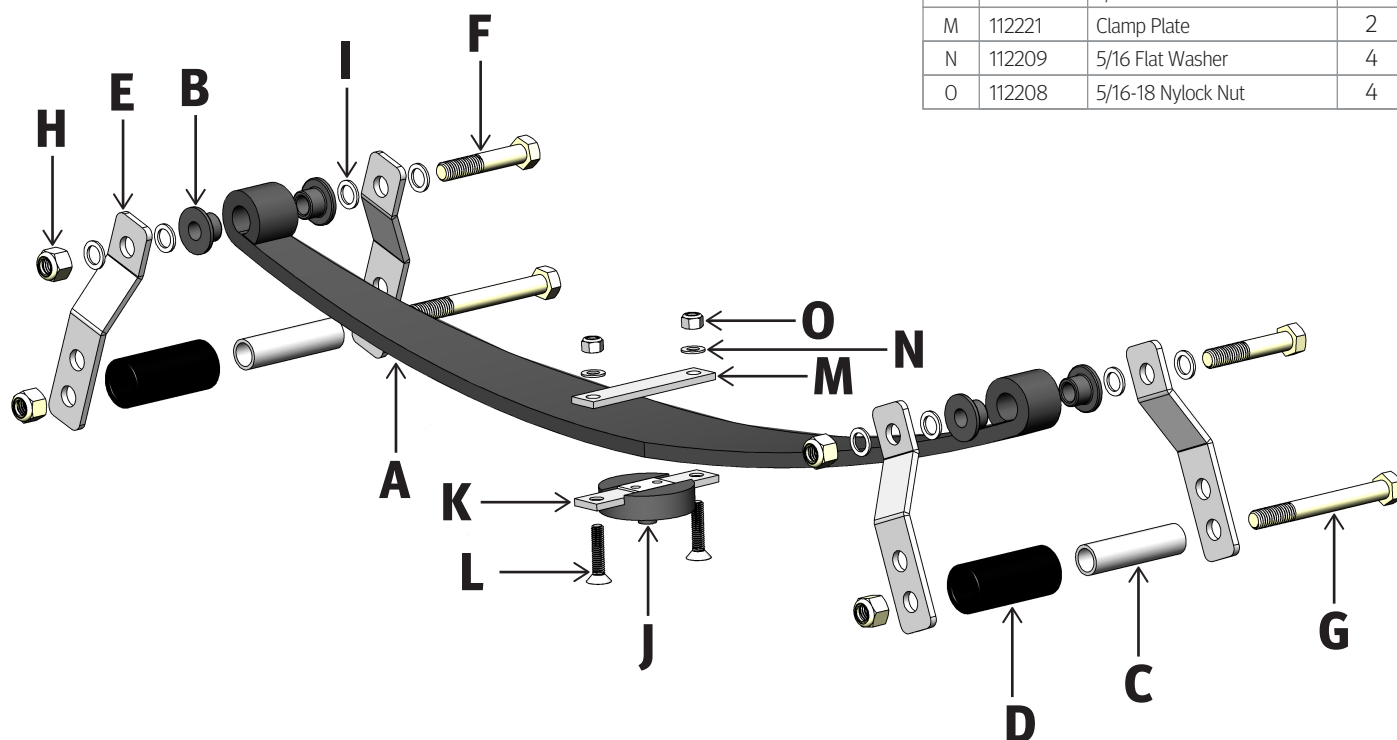

Part Number: SSA29

Product Line: SUPERSPRINGS

Page 1

Questions or Concerns?

Scan here:



or visit:
superspringsinternational.com

SAFETY NOTICE: We recommend installation be done by a professional or persons with sound mechanical knowledge.

WARNING: These instructions are a general guide for installation. SuperSprings International (SSI) assumes no liability for the actual installation process. Consumers and installers should apply common automotive safety practices when raising and working on any vehicle. **Do not put yourself in a position where, if the vehicle were to move unexpectedly, you may be injured.** SSI's products are designed to improve vehicle ride quality. Do not load any vehicle beyond the manufacturer's specifications.

Never exceed the manufacturer's Gross Vehicle Rating (GVWR) located on your vehicles identification tag.

BEFORE INSTALLATION: Ensure the vehicle is on a hard level surface, the parking brake is ON, with the ignition OFF, and place chocks in front of and behind the tires to prevent the vehicle from moving.

DURING AND/OR AFTER INSTALLATION: Ensure emergency brake cables are not touching the SSI products. Secure any cables out of the way with zip ties or by re-routing. Ensure all A/C lines, brake cables, and frame are clear of contact or interference.

REV. 2.01 | OCT 2023

PART NUMBER
SSA29



INSTALLATION

1. Positioning the vehicle – Vehicle must be on level solid surface. Ensure emergency brake is ON and Ignition is OFF. Chock both front and rear of the front tires to prevent the vehicle from moving.
2. Jack up vehicle – elevate and support the frame securing with jack stands so that the axle is hanging with tires slightly off the ground. Wheel removal is suggested ONLY were bodies are mounted.
3. The SSA29 does not have a dedicated front and rear. However, the threaded ends of the spring eye and roller bolts should be pointing outboard, away from the frame.
4. Attach PSP-6 [ITEM J] to the underside of the SuperSpring with the provide hardware. The PSP-6 comes preassembled in a plastic bag in the box with the springs. Leave the hardware loose so that it can be adjusted during installation.
5. Place the SuperSpring assembly above the factory leaf pack, positioning it with the PSP-6 fitted into the factory bump stop receiver. Adjust the SuperSpring position so there is sufficient clearance from any frame contact both horizontally and vertically.
6. Shackle Attachment - Note: The top/spring eye shackle bolts are factory pre-torqued; no adjustment/further tightening is needed. If any are loosened by the installer then re-torque to 30 ft. lbs.
7. **Shackle Attachment Front** - Rotate the front shackles legs down on both sides of the leaf spring. Using ITL-1 or other high capacity clamp(s), compress the SuperSprings and factory leaf pack together. Place the Sleeve [ITEM C] and the Roller [ITEM D] between the Shackles and align with desired preload holes. Secure with ½-13 x 4 ½" Hex Bolt [ITEM G] and ½-13 Lock Nut [ITEM H]. Torque to 25 ft. lbs.
8. **Shackle Attachment Rear** – Rotate the rear shackles legs down on both sides of the leaf spring. Using ITL-1 or other high capacity clamp(s), compress the SuperSprings and factory leaf pack together. Place the Sleeve [ITEM C] and the Roller [ITEM D] between the Shackles and align with the upper preload holes. Secure with 1/2-13 x 4 ½" Hex Bolt [ITEM G] and ½-13 Lock Nut [ITEM H]. Torque to 25 ft. lbs.
9. Adjust spring location front to back so that the Rollers have minimum ½" of clearance from spring clamps or the end of the next shorter leaf. Also confirm that there is adequate clearance around the SuperSpring from the frame, brake lines, harnesses, etc. In some cases, it may be necessary to bend routing brackets to adjust position of the brake lines or harnesses for clearance.

Part Number: SSA29

Product Line: SUPERSPRINGS

Page 2

Questions or Concerns?

Scan here:



or visit:
superspringsinternational.com

SAFETY NOTICE: We recommend installation be done by a professional or persons with sound mechanical knowledge.

WARNING: These instructions are a general guide for installation. SuperSprings International (SSI) assumes no liability for the actual installation process. Consumers and installers should apply common automotive safety practices when raising and working on any vehicle. **Do not put yourself in a position where, if the vehicle were to move unexpectedly, you may be injured.** SSI's products are designed to improve vehicle ride quality. Do not load any vehicle beyond the manufacturer's specifications.

Never exceed the manufacturer's Gross Vehicle Rating (GVWR) located on your vehicles identification tag.

BEFORE INSTALLATION: Ensure the vehicle is on a hard level surface, the parking brake is ON, with the ignition OFF, and place chocks in front of and behind the tires to prevent the vehicle from moving.

DURING AND/OR AFTER INSTALLATION: Ensure emergency brake cables are not touching the SSI products. Secure any cables out of the way with zip ties or by re-routing. Ensure all A/C lines, brake cables, and frame are clear of contact or interference.

REV. 2.01 | OCT 2023

PART NUMBER
SSA29



INSTALLATION

10. Secure Lock-down Hardware – Tighten the PSP-6 mounting hardware securely.
 11. Repeat steps 3 through 10 on the other side.
 12. Lower the vehicle – elevate chassis, remove the jack stands, lower to the ground. Remove wheel chocks from front wheels.
 13. Final Check – Check the position of the SuperSprings ensuring for correct hardware application and orientation. Observe all hardware ensuring for static and dynamic interference clearances. Recheck all hardware to ensure it is securely tightened.
- NOTE:** After 200-500 miles of driving, recheck all hardware again for tightness.
14. Register the warranty for your SuperSprings International part. A warranty card can be found in the box your part came in.

Part Number: SSA29

Product Line: SUPERSPRINGS

Page 3

Questions or Concerns?

Scan here:



or visit:
superspringsinternational.com

SAFETY NOTICE: We recommend installation be done by a professional or persons with sound mechanical knowledge.

WARNING: These instructions are a general guide for installation. SuperSprings International (SSI) assumes no liability for the actual installation process. Consumers and installers should apply common automotive safety practices when raising and working on any vehicle. **Do not put yourself in a position where, if the vehicle were to move unexpectedly, you may be injured.** SSI's products are designed to improve vehicle ride quality. Do not load any vehicle beyond the manufacturer's specifications.

Never exceed the manufacturer's Gross Vehicle Rating (GVWR) located on your vehicles identification tag.

BEFORE INSTALLATION: Ensure the vehicle is on a hard level surface, the parking brake is ON, with the ignition OFF, and place chocks in front of and behind the tires to prevent the vehicle from moving.

DURING AND/OR AFTER INSTALLATION: Ensure emergency brake cables are not touching the SSI products. Secure any cables out of the way with zip ties or by re-routing. Ensure all A/C lines, brake cables, and frame are clear of contact or interference.

REV. 2.01 | OCT 2023